

Stainless Steel One-touch Fittings

KG Series

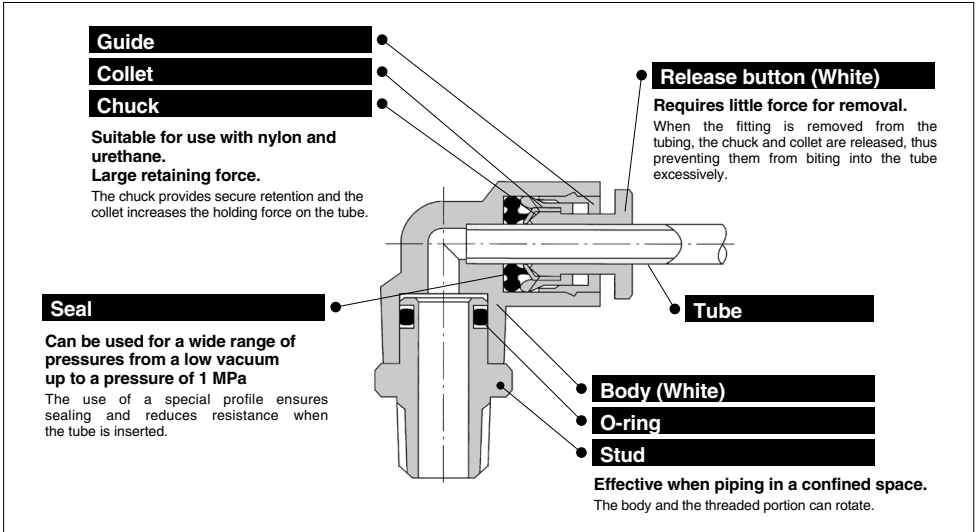

Stainless steel specifications applicable to corrosive environments

Stainless steel 303 adopted for metal elements

Suitable for use in CRT production lines where contact with copper must be avoided, food processing machines where water or salt water splashes and clean room where discoloration of copper material and corrosion must be avoided.



Applicable Tubing

Tubing material	FEP, PFA, Nylon, Soft nylon, ⁽¹⁾ Polyurethane
Tubing O.D.	ø4, ø6, ø8, ø10, ø12, ø16

Note 1) Soft nylon tubing is not compatible with water.

Specifications

Fluid		Air/Water ^(2, 3)
Operating pressure range ⁽⁴⁾		-100 kPa to 1 MPa
Proof pressure		3 MPa
Ambient and fluid temperature		-5 to 60°C (Water: 0 to 40°C) (No freezing)
Thread	Mounting section	JIS B 0203 (Taper thread for piping) JIS B 0205 (Metric coarse thread)
	Nut section	JIS B 0205 (Metric fine thread)
Seal on the threads		With sealant or none ⁽⁵⁾

Note 2) The surge pressure must be under the maximum operating pressure.

Note 3) Deionized water is not recommended for use as it may affect the material used in the fittings.

In addition, it is known to degrade the water quality.

Note 4) Do not use the fittings with a leak tester or for vacuum retention because they are not guaranteed for zero leakage.

Note 5) Suffix "S" to the part number, if w/ seal is desired.

Principal Parts Material

Body	Stainless steel 303, PBT
Stud	Stainless steel 303 (Thread portion)
Chuck	Stainless steel 304
Guide	Stainless steel 304, Stainless steel 303, PBT
Collet, Release button	POM
Seal, O-ring	NBR
Gasket	Stainless steel 304, NBR



Made to Order
(Refer to page 448 for details.)



KG Series

Model

Hex. socket head male connector

KGK P.439



Internal hex. allows thread connection by using an allen wrench for confined spaces.

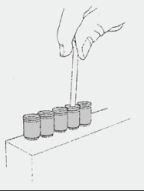

Bulkhead union

KGE P.447



Use to connect tubes through a panel.

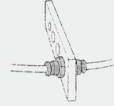

Universal male elbow

KGV P.441



Universal male elbow allows thread connection by using a socket wrench for confined spaces.

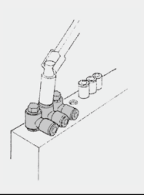

Extended male elbow

KGW P.443



Basically, it is used together with male elbow. Different point is that it is used for fittings to avoid from interfering with each other by making the pipin two-level.

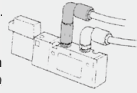

Bulkhead connector

KGE P.447



Use to connect male thread and tube through a panel.

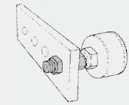

Male connector

KGH P.439



Use to pipe in the same direction from female thread. Most general type.

Male elbow

KGL P.440



Use to pipe at right angles to female thread. Most general type.

Male branch tee

KGT P.443



Use to branch line from female thread in both 90° directions.

Female connector

KGK P.440



Use to pipe from male thread such as pressure gauge.

Union elbow

KGL P.442



Use to connect tubes at right angles.

Union tee

KGT P.443



Use to connect tubes in both 90° directions.

Straight union

KGH P.440



Use to connect tubes in the same direction.

Plug-in elbow

KGL P.442



Use to change by 90° in a tube fetching direction from One-touch fittings.

Different diameter tee

KGT P.444



Use to connect tubes with size down in both 90° directions.

Different diameter straight

KGH P.440



Use to connect different sized tubes.

Male delta union

KGD P.444



Use to branch line in 90° direction from female thread.

Male run tee

KGY P.444



Use to branch line in the same direction from female thread and in 90° direction.

Branch male elbow

KGLU P.441



Use to branch line at right angles to female thread.

Delta union

KGD P.445



Use to branch line in tripple 90° direction.

Different dia. double union "Y"

KGUD P.446



Use to four-branch line in the same direction.

Branch union elbow

KGLU P.442



Use to branch line at right angles.

Delta branch

KGUD P.445



Use to four-branch line in the same direction from female thread.

Union "Y"

KGU P.446



Use to branch line in the same direction.

Model

Different dia. union "Y"

KGU P.446



Use to connect tubes in the same direction, reducing the size of tubes.

Plug-in reducer

KGR P.446



Use to change size of One-touch fittings.

Tube cap

KGC P.447



Use to plug unused tubing.

Branch

KGU P.445



Use to branch line in the same direction from the female thread.



Male Connector: KGH

<M5>

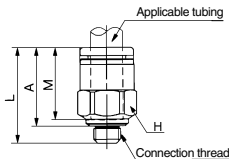

<R>

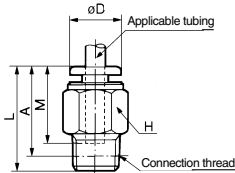

Applicable tubing O.D. (mm)	Connection thread M/R	Model	H (width across flats)	L	A*	M	Effective area (mm ²)		Weight (g)
							Nylon	Urethane	
4	M5 x 0.8	KGH04-M5	8	17	13.9	12.7	4	4	2.4
	1/8	KGH04-01	10	21.1	18	16	5.6	4	9
	1/4	KGH04-02	14	19	13.5				
6	M5 x 0.8	KGH06-M5	10	17.8	14.7	13.5	4	4	3.4
	1/8	KGH06-01	12	21.6	18.5	17	13.1	10.4	16
	1/4	KGH06-02	14	22.5	17				
	3/8	KGH06-03	17	20.9	15.5	27			
8	1/8	KGH08-01	14	27.1	24	18.5	26.1	18.0	21
	1/4	KGH08-02		26	20.5				19
	3/8	KGH08-03	17	20.9	15.5				26
10	1/8	KGH10-01	17	29.1	26	21	41.5	29.5	19
	1/4	KGH10-02		33	27.5				30
	3/8	KGH10-03		27.9	22.5				30
	1/2	KGH10-04		22	26.1				19
12	1/4	KGH12-02	19	34	28.5	22	58.3	46.1	42
	3/8	KGH12-03		28.9	23.5				34
	1/2	KGH12-04		22	29.1				22
16	3/8	KGH16-03	24	38.4	32	24	81	(81)	61
	1/2	KGH16-04		34.6	26.5				47

* Reference dimensions after R thread installation.
Note) (): Values for soft nylon.

Hexagon Socket Head Male Connector: KGS

<M5>

<R>

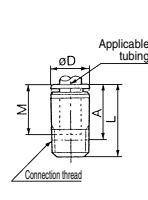
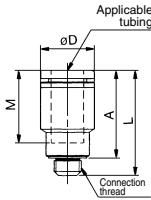

Applicable tubing O.D. (mm)	Connection thread M/R	Model	H (width across flats)	ϕD	L	A*	M	Effective area (mm ²)		Weight (g)
								Nylon	Urethane	
4	M5 x 0.8	KGS04-M5	2.5	8	18.7	15.6	12.7	4	4	2.6
	1/8	KGS04-01	3	9.8	23	19	16	4.1	3.6	8
6	M5 x 0.8	KGS06-M5	2.5	10	19.5	16.4	13.5	4	4	3.2
	1/8	KGS06-01	4	11.8	20	17	10.0	9.9	9	
	1/4	KGS06-02		13.8	24					18
8	1/8	KGS08-01	5	14	28	24	18.5	23.3	16.2	12
	1/4	KGS08-02	25.5		19.5	11				
	3/8	KGS08-03	6	17	27.5	21.5				24
10	1/8	KGS10-01	5	17	30	26	21	39.0	26.6	18
	1/4	KGS10-02	27.5		21.5	12				
	3/8	KGS10-03	8		25	20				19
	1/2	KGS10-04	22		28	20				35
12	1/4	KGS12-02	8	19	33.5	27.5	22	60.0	44.5	23
	3/8	KGS12-03	29		22.5	18				
	1/2	KGS12-04	22		28	20				30

* Reference dimensions after R thread installation.

KG Series

Female Connector: KGF

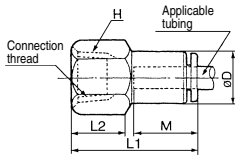

Applicable tubing O.D. (mm)	Connection thread Rc thread	Model	H (width across flats)	øD	L1	L2	M	Effective area (mm ²)		Weight (g)
								Nylon	Urethane	
4	1/8	KGF04-01	14	10	27	11	16	5.6	4	15
	1/4	KGF04-02	17		31	14				23
6	1/8	KGF06-01	14	12	27.5 11		17	13.1	10.4	15
	1/4	KGF06-02	17		31	13				22
	3/8	KGF06-03	19		33.5	15				25
8	1/8	KGF08-01	14	14	29	11	18.5	26.1	18.0	17
	1/4	KGF08-02	17		32.5	13				24
	3/8	KGF08-03	19		33.5	14				24
10	1/4	KGF10-02	17	17	34.5	14	21	41.5	29.5	27
	3/8	KGF10-03	19		36.5	15				30
12	1/4	KGF12-02	19	19	35	14	22	58.3	46.1	36
	3/8	KGF12-03			37					31
	1/2	KGF12-04			41					18

Straight Union: KGH

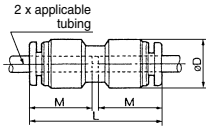

Applicable tubing O.D. (mm)	Model	øD	L	M	Effective area (mm ²)		Weight (g)
					Nylon	Urethane	
4	KGH04-00	10.4	32.5	16	5.6	4	3
6	KGH06-00	12.8	34.5	17	13.1	10.4	4
8	KGH08-00	15.2	38.5	18.5	26.1	18.0	6
10	KGH10-00	18.5	42.5	21	41.5	29.5	11
12	KGH12-00	20.9	44.5	22	58.3	46.1	14

Different Diameter Straight: KGH

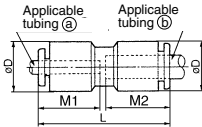

Applicable tubing O.D. (mm)		Model	øD	L	M1	M2	Effective area (mm ²)		Weight (g)
(a)	(b)						Nylon	Urethane	
4	6	KGH04-06	12.8	34.5	16	17	5.6	4	5
6	8	KGH06-08	15.2	38.5	17	18.5	13.1	10.4	6
8	10	KGH08-10	18.5	42	18.5	21	26.1	18.0	11
10	12	KGH10-12	20.9	44.5	21	22	41.5	29.5	14

Male Elbow: KGL



<M5>

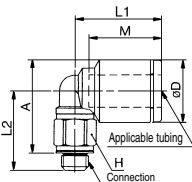

<R>

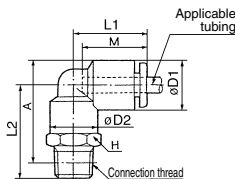

Applicable tubing O.D. (mm)	Connection thread M R	Model	H (width across flats)	øD1	øD2	L1	L2	A*	M	Effective area (1) ⁽¹⁾ mm ²		Weight (g)
										Nylon	Urethane	
4	M5 x 0.8	KGL04-M5	7	9.3	—	15.6	13.7	15.3	12.7	3.5	3.5	2.7
	1/8	KGL04-01	10	10.4	10	18	21.1	23	16	4.2	4.2	10
	1/4	KGL04-02	14				25.5	25				19
6	M5 x 0.8	KGL06-M5	7	11.6	—	16.1	14.7	17.4	13.5	3.5	3.5	3.1
	1/8	KGL06-01	10	12.8	10	20	22.1	25.5	17	11.4	9.0	12
	1/4	KGL06-02	14				26.5	27.5				10
3/8	KGL06-03	17	27.9				29	33				
8	1/8	KGL08-01	12	15.2	12	23	23.6	28	18.5	21.6	14.9	13
	1/4	KGL08-02	14				28	30				21
	3/8	KGL08-03	17				29.4	31.5				35
10	1/8	KGL10-01	17	18.5	17	26.5	26.1	32	21	35.2	25.0	25
	1/4	KGL10-02					29.5	33				26
	3/8	KGL10-03					30.9	34.5				36
	1/2	KGL10-04					35.1	37				63
12	1/4	KGL12-02	17	20.9	17	28.5	30.5	35.5	22	50.2	39.7	28
	3/8	KGL12-03					31.9	37				38
	1/2	KGL12-04					36.1	39.5				65
16	3/8	KGL16-03	22	26.5	20.9	34	36.9	44.5	24	71	(71)	101
	1/2	KGL16-04					40.1	46				105

* Reference dimensions after R thread installation.
Note 1) (): Values for soft nylon.



Branch Male Elbow: KGLU

<M5>

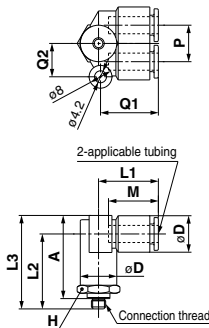

Applicable tubing O.D. (mm)	Connection thread M R	Model	H (width across flats)	øD	L1	L2	L3	A*	M	P	Q1	Q2	Effective area (mm ²)		Weight (g)
													Nylon	Urethane	
4	M5 x 0.8	KGLU04-M5	11	10.4	18.5	24	29.5	25.5	16	10.4	18.5	10	4.3	4.1	10
		KGLU04-01	14			30	35.5	30					6.0	4.1	12
6	M5 x 0.8	KGLU06-M5	13	12.8	21	26.5	33	29.5	17	12.8	20.5	12	4.3	4.3	13
		KGLU06-01	14			28.6	35.1	32					15		
		KGLU06-02	14			32.5	39	33.5					19.9	11.0	22
		KGLU06-03	17			33.9	40.4	35					35		
8	M5 x 0.8	KGLU08-01	17	15.2	24	33.1	40.6	38	18.5	15.2	24.5	14	26.3	18.2	27
		KGLU08-02	17			36.5	44	38.5					35		
		KGLU08-03	17			36.9	44.4	39					35		
10	M5 x 0.8	KGLU10-02	19	18.5	27	39.5	49	43.5	21	18.5	28	16	40.8	29.0	42
		KGLU10-03	19			38.9	49.4	44					42		
		KGLU10-04	22			43.6	53.1	45.5					64		
12	M5 x 0.8	KGLU12-02	22	20.9	29	42	52.5	47	22	20.9	30	18	57.2	45.2	57
		KGLU12-03	22			42.4	52.9	47.5					58		
		KGLU12-04	22			45.6	56.1	49					65		

* Reference dimensions after R thread installation.

<R>

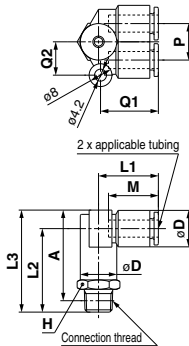

Universal Male Elbow: KGV

<M5>

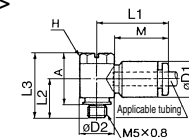

Applicable tubing O.D. (mm)	Connection thread M R	Model	H (width across flats)	øD1	øD2	L1	L2	L3	A*	M	Effective area (mm ²)		Weight (g)
											Nylon	Urethane	
4	M5 x 0.8	KGV04-M5	8	10.4	9.8	20.5	11	18.5	15	16	2.9	2.9	6
		KGV04-01			13.4	22	13.6	25.6	22.5		14		
6	M5 x 0.8	KGV06-M5	8	12.8	9.8	23.5	12	18.5	15	17	3.8	3.8	7
		KGV06-01			13.4	24	13.6	25.6	22.5		15		
		KGV06-02			15.3	23.5	18	30.5	25		7.5	5.9	26
8	M5 x 0.8	KGV08-01	12	15.2	17.6	28.5	14.6	27.6	24.5	18.5	16	11.2	24
		KGV08-02	12		18	31	25.5	30	30				
		KGV08-03	14		20.6	27.5	19.4	35.4	30		20.5	14.3	47
10	M5 x 0.8	KGV10-02	14	18.5	20.6	31	19	35	29.5	21	27	20.3	40
		KGV10-03	14				19.4	35.4	30				49
12	M5 x 0.8	KGV12-03	17	20.9	25.2	34	20.9	37.4	32	22	39	30.8	63
		KGV12-04					24.1	40.6	33.5				80

* Reference dimensions after R thread installation.

<R>

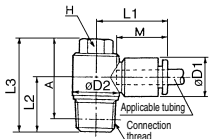



Union Elbow: KGL

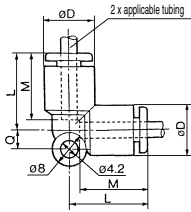

Applicable tubing O.D. (mm)	Model	ϕD	L	Q	M2	Effective area (mm ²)		Weight (g)
						Nylon	Urethane	
4	KGL04-00	10.4	18	4.5	16	4.2	4.2	6
6	KGL06-00	12.8	20	5.3	17	11.4	9.0	6
8	KGL08-00	15.2	23	6	18.5	21.6	14.9	10
10	KGL10-00	18.2	26.5	6.8	21	35.2	25.0	17
12	KGL12-00	20.9	28.5	7.5	22	50.2	39.7	21
16	KGL16-00	26.5	34	10	25	100	(84)	29

Note 1) (): Values for soft nylon.



Branch Union Elbow: KGLU

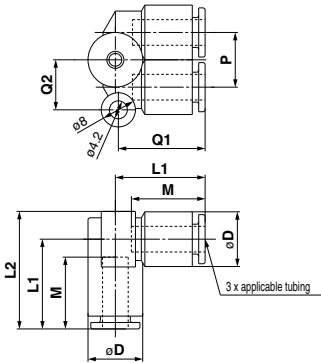

Applicable tubing O.D. (mm)	Model	ϕD	L1	L2	Q1	Q2	M	P	Effective area (mm ²)		Weight (g)
									Nylon	Urethane	
4	KGLU04-00	10.4	18.5	24	18.5	10	16	10.4	6.0	4.1	6
6	KGLU06-00	12.8	21	27.5	20.5	12	17	12.8	13.9	11.0	8
8	KGLU08-00	15.2	24	32	24.5	14	18.5	15.2	26.3	18.2	15
10	KGLU10-00	18.5	27	36.5	28	16	21	18.5	40.8	29.0	25
12	KGLU12-00	20.9	29	40	30	18	22	20.9	57.2	45.2	32

Plug-in Elbow: KGL

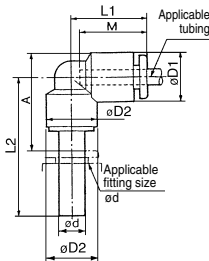

Applicable tube O.D. mm	Applicable fitting size ϕd	Model	$\phi D1$	$\phi D2$	L1	L2	A	M	Effective area (mm ²)		Weight (g)
									Nylon	Urethane	
4	4	KGL04-99	10.4	8	18	25	14.5	16	4.2	4.2	8
6	6	KGL06-99	12.8	10	20	27.5	17	17	11.4	9.0	10
8	8	KGL08-99	15.2	12	22.5	31.5	21	18.5	21.6	14.9	14
10	10	KGL10-99	18.5	14	25.5	35.5	23.5	21	35.2	25.0	25
12	12	KGL12-99	20.9	16	27	37.5	26	22	50.2	39.7	28





Extended Male Elbow: KGW

<M5>

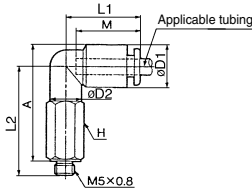

<R>

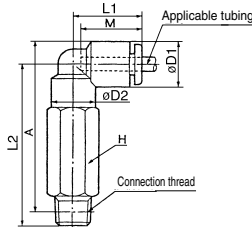

Applicable tubing O.D. (mm)	Connection thread M/R	Model	H (width across flats)	øD1	øD2	L1	L2	A*	M	Effective area (mm ²)		Weight (g)
										Nylon	Urethane	
4	M5x0.8	KGW04-M5	7	10.4	8	18	30	32	16	3.0	3.0	11
	1/8	KGW04-01	10				36.6	38.5		4.0	4.0	23
	1/4	KGW04-02	14				43	42.5				38
6	M5x0.8	KGW06-M5	8	12.8	8	20	30.5	33.5	17	3.0	3.0	11
	1/8	KGW06-01	10				39.1	42.5				26
	1/4	KGW06-02	14				45.5	46.5				41
	3/8	KGW06-03	17				46.9	48				67
	1/2	KGW06-04	22				42.6	47				30
8	1/8	KGW08-01	12	15.2	12	23	49	51	18.5	20.5	14.2	47
	1/4	KGW08-02	14				50.4	52.5				74
	3/8	KGW08-03	17				56	59.5				66
10	1/4	KGW10-02	17	18.5	17	26.5	57.4	61	21	33.5	23.8	76
	3/8	KGW10-03	17				64.1	66				145
	1/2	KGW10-04	22				57	62				68
12	1/4	KGW12-02	17	20.9	17	28.5	58.4	63.5	22	47.7	37.7	78
	3/8	KGW12-03	17				65.1	68.5				147
	1/2	KGW12-04	22									

* Reference dimensions after R thread installation.



Male Branch Tee: KGT

<M5>

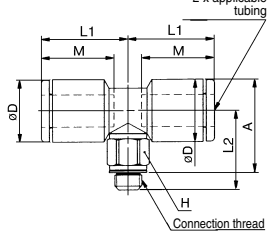

<R>

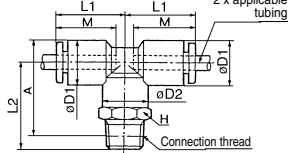

Applicable tubing O.D. (mm)	Connection thread M/R	Model	H (width across flats)	øD1	øD2	L1	L2	A*	M	Effective area (1) (mm ²)		Weight (g)
										Nylon	Urethane	
4	M5x0.8	KGT04-M5	7	9.3	—	15.6	13.7	15.3	12.7	4.3	4.3	3.5
	1/8	KGT04-01	10	10.4	10	18	21.1	23	16	6.0	4.1	13
	1/4	KGT04-02	14	11.6	—	16.1	14.7	17.4	13.5	4.3	4.3	4.2
6	M5x0.8	KGT06-M5	7	12.8	10	20	22.1	25.5	17	13.9	11.0	20
	1/8	KGT06-01	10				26.5	27.5				34
	1/4	KGT06-02	14				27.9	29				14
	3/8	KGT06-03	17				28	30				22
	1/2	KGT06-04	22				29.4	31.5				36
8	1/8	KGT08-01	12	15.2	12	23	26.1	32	18.5	26.3	18.2	31
	1/4	KGT08-02	14				28	30				22
	3/8	KGT08-03	17				29.4	31.5				36
10	1/8	KGT10-01	12	18.5	17	26.5	26.1	32	21	40.8	29.0	31
	1/4	KGT10-02	17				29.5	33				29
	3/8	KGT10-03	17				30.9	34.5				39
	1/2	KGT10-04	22				35.1	37				66
	1/4	KGT12-02	17				30.5	35.5				31
12	3/8	KGT12-03	17	20.9	17	28.5	31.9	37	22	57.2	45.2	41
	1/2	KGT12-04	22				36.1	39.5				68
	3/8	KGT16-03	22				36.9	44.5				71 (71)
16	1/2	KGT16-04	22	26.5	20.9	34	39.6	46	25	100 (100)	116	

* Reference dimensions after R thread installation.
Note 1) (): Values for soft nylon



Union Tee: KGT

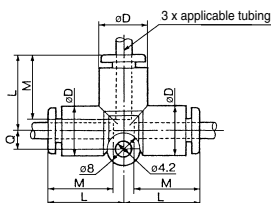

Applicable tubing O.D. (mm)	Model	øD	L	Q	M	Effective area (1) (mm ²)		Weight (g)
						Nylon	Urethane	
4	KGT04-00	10.4	18	4.5	16	6.4	4.4	7
6	KGT06-00	12.8	20	5.3	17	13.4	10.6	10
8	KGT08-00	15.2	23	6	18.5	25.6	17.7	15
10	KGT10-00	18.5	26.5	6.8	21	40	28.4	25
12	KGT12-00	20.9	28.5	7.5	22	57.4	45.4	29
16	KGT16-00	26.5	34	10	25	100	(84)	40

Note 1) (): Values for soft nylon.

KG Series



Different Diameter Tee: KGT

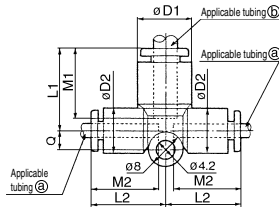

Applicable tubing O.D. (mm)	Model	øD1	øD2	L1	L2	Q	M1	M2	Effective area (mm ²)		Weight (g)
									Nylon	Urethane	
4 6	KGT04-06	12.8	10.4	19.5	18	4.5	17	16	7.1	6.5	5
6 8	KGT06-08	15.2	12.8	22.5	20	5.3	18.5	17	16.4	16.4	8
8 10	KGT08-10	18.5	15.2	26.5	23	6	21	18.5	36	27.2	14
10 12	KGT10-12	20.9	18.5	28.5	26.5	6.8	22	21	56	44.5	21



Male Run Tee: KGY

<M5>

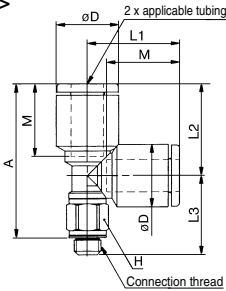

<R>

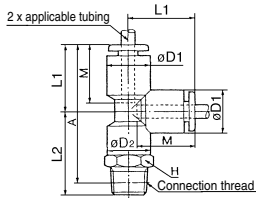

Applicable tubing O.D. (mm)	Connection thread M/R	Model	H (width across flats)	øD1	øD2	L1	L2	L3	A*	M	Effective area ⁽¹⁾ (mm ²)		Weight (g)
											Nylon	Urethane	
4	M5 x 0.8	KGY04-M5	7	9.3	—	15.6	14.8	13.7	25.4	12.7	4.6	4.6	3.5
		1/8 KGY04-01	10	10.4	10	18	21.1	—	36	16	6.4	4.4	13
		1/4 KGY04-02	14	—	—	—	25.5	—	38	—	—	—	—
6	M5 x 0.8	KGY06-M5	7	11.6	—	17.1	17.1	14.7	28.7	13.5	4.6	4.6	4.3
		1/8 KGY06-01	10	—	—	—	22.1	—	39	—	—	—	12
		1/4 KGY06-02	14	12.8	10	20	26.5	—	41	17	13.4	10.6	20
		3/8 KGY06-03	17	—	—	—	27.9	—	42.5	—	—	—	34
8	M5 x 0.8	KGY08-01	12	—	—	—	—	—	43.5	17	13.4	10.6	14
		1/4 KGY08-02	14	15.2	12	23	28	—	45.5	—	—	—	22
		3/8 KGY08-03	17	—	—	—	29.4	—	47	18.5	25.6	17.7	36
10	M5 x 0.8	KGY10-01	11	—	—	—	—	—	49.5	—	—	—	31
		1/4 KGY10-02	17	18.5	17	26.5	29.5	—	50.5	21	40.0	28.4	29
		3/8 KGY10-03	22	—	—	—	30.9	—	52	—	—	—	39
		1/2 KGY10-04	22	—	—	—	35.1	—	54.5	—	—	—	66
12	M5 x 0.8	KGY12-02	17	—	—	—	—	—	53.5	—	—	—	31
		3/8 KGY12-03	22	20.9	17	28.5	31.9	—	55	22	57.4	45.4	41
		1/2 KGY12-04	22	—	—	—	36.1	—	57.5	—	—	—	68
16	M5 x 0.8	KGY16-03	22	26.5	20.9	34	40.1	—	65.5	—	—	—	112
		KGY16-04	22	—	—	—	36.9	—	67	25	81	(81)	116

* Reference dimensions after R thread installation.
Note 1 () : Values for soft nylon.



Male Delta Union: KGD

<M5>

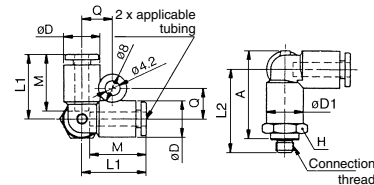

<R>

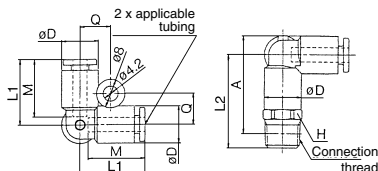

Applicable tubing O.D. (mm)	Connection thread M/R	Model	H (width across flats)	øD	L1	L2	A*	M	Q	Effective area (mm ²)		Weight (g)	
										Nylon	Urethane		
4	M5 x 0.8	KGD04-M5	11	—	—	24	25.5	—	—	—	4.3	4.3	10
		1/8 KGD04-01	11	10.4	18.5	25.6	27.5	—	16	8.7	6.0	6.0	12
		1/4 KGD04-02	14	—	—	30	30	—	—	—	—	—	—
6	M5 x 0.8	KGD06-M5	13	—	—	26	28.5	—	—	—	4.3	4.3	12
		1/8 KGD06-01	13	12.8	20.5	28.1	31.5	—	17	9.9	13.9	11.0	21
		1/4 KGD06-02	14	—	—	32	33	—	—	—	—	—	34
		3/8 KGD06-03	17	—	—	33.4	34.5	—	—	—	—	—	21
8	M5 x 0.8	KGD08-01	13	—	—	32.6	37	—	—	—	—	—	26
		1/4 KGD08-02	17	15.2	23.5	36	38	—	18.5	11.1	26.3	18.2	35
		3/8 KGD08-03	17	—	—	36.4	38.5	—	—	—	—	—	39
10	M5 x 0.8	KGD10-02	19	—	—	39	43	—	—	—	—	—	39
		3/8 KGD10-03	19	18.5	26.5	39.4	43.5	—	21	12.8	40.8	29.0	40
		1/2 KGD10-04	22	—	—	43.1	45	—	—	—	—	—	62
12	M5 x 0.8	KGD12-02	22	—	—	41.5	46.5	—	—	—	—	—	55
		3/8 KGD12-03	22	20.9	28.5	41.9	47	—	22	13.9	57.2	45.2	56
		1/2 KGD12-04	22	—	—	45.1	48.5	—	—	—	—	—	63

* Reference dimensions after R thread installation.



Delta Union: KGD

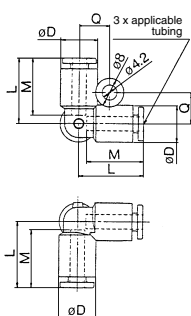

Applicable tubing O.D. (mm)	Model	øD	L	Q	M	Effective area (mm ²)		Weight (g)
						Nylon	Urethane	
4	KGD04-00	10.4	18.5	8.7	16	6.0	4.1	5
6	KGD06-00	12.8	20.5	9.9	17	13.9	11.0	7
8	KGD08-00	15.2	23.5	11.1	18.5	26.3	18.2	11
10	KGD10-00	18.5	26.5	12.8	21	40.8	29.0	19
12	KGD12-00	20.9	28.5	13.9	22	57.2	45.2	24



Branch "Y": KGU

<M5>

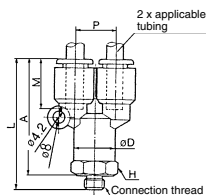

Applicable tubing O.D. (mm)	Connection thread M R	Model	H (width across flats)	øD	L	P	A*	M	Effective area (mm ²)		Weight (g)
									Nylon	Urethane	
4	M5 x 0.8	KGU04-M5	11	10.4	11.1	10.4	36	16	2.2	2.2	4
	1/8	KGU04-01							4.2	4.2	11
	1/4	KGU04-02							20		
6	M5 x 0.8	KGU06-M5	13	12.8	12.8	39	41.5	17	2.2	2.2	12
	1/8	KGU06-01							11		
	1/4	KGU06-02							21		
	3/8	KGU06-03							34		
8	M5 x 0.8	KGU08-M5	17	15.2	15.2	49.5	18.5	25.6	17.7	17.7	23
	1/8	KGU08-01							15		
	1/4	KGU08-02							35		
10	M5 x 0.8	KGU10-M5	19	18.5	18.5	55.5	21	40	28.4	28.4	40
	1/8	KGU10-01							30		
	1/4	KGU10-02							65		
	3/8	KGU10-03							65		
12	M5 x 0.8	KGU12-M5	22	20.9	20.9	60.5	22	57.4	45.4	45.4	60
	1/8	KGU12-01							32		
	1/4	KGU12-02							40		
	3/8	KGU12-03							65		

* Reference dimensions after R thread installation.

<R>

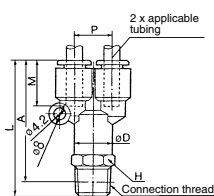

Delta Branch: KGUD

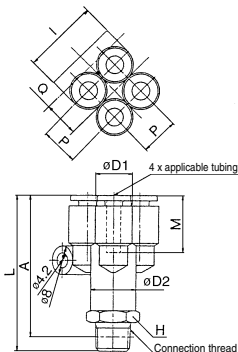

Applicable tubing O.D. (mm)	Connection thread R thread	Model	H (width across flats)	øD1	øD2	L	I	A*	Q	M	P	Effective area (mm ²)		Weight (g)
												Nylon	Urethane	
4	1/8	KGUD04-01	13	10.4	12.8	42.6	21	39.5	9.7	16	10.4	4.2	4.2	17
	1/4	KGUD04-02	14									25		
6	1/8	KGUD06-01	17	12.8	15.2	49.6	26	46.5	11.7	17	12.8	10.6	10.6	29
	1/4	KGUD06-02										53		

* Reference dimensions after R thread installation.

KG Series



Union "Y": KGU

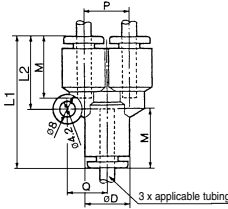

Applicable tubing O.D. (mm)	Model	ϕD	L1	L2	P	Q	M	Effective area (mm ²)		Weight (g)
								Nylon	Urethane	
4	KGU04-00	10.4	34	18	10.4	9.7	16	4.2	4.2	7
6	KGU06-00	12.8	37	20	12.8	11.7	17	13.4	10.6	9
8	KGU08-00	15.2	42.5	24.5	15.2	13.7	18.5	25.6	17.7	11
10	KGU10-00	18.5	48	27.5	18.5	16.1	21	40	28.4	16
12	KGU12-00	20.9	51	30	20.9	18.1	22	57.4	45.4	23



Different Diameter Union "Y": KGU

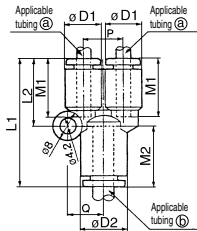

Applicable tubing O.D. (mm)		Model	$\phi D1$	$\phi D2$	L1	L2	P	Q	M1	M2	Effective area (mm ²)		Weight (g)
(a)	(b)										Nylon	Urethane	
4	6	KGU04-06	10.4	12.8	35	18	10.4	9.7	16	17	4.2	4.2	6
6	8	KGU06-08	12.8	15.2	39.5	20	12.8	11.7	17	18.5	13.4	10.6	11
8	10	KGU08-10	15.2	18.5	45	24.5	15.2	13.7	18.5	21	25.6	17.7	18
10	12	KGU10-12	18.5	20.9	49	27.5	18.5	16.1	21	22	40	28.4	27



Different Diameter Double Union "Y": KGD

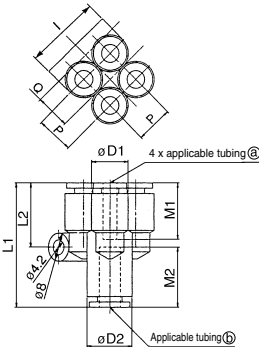

Applicable tubing O.D. (mm)		Model	$\phi D1$	$\phi D2$	L1	L2	P	I	Q	M1	M2	Effective area (mm ²)		Weight (g)
(a)	(b)											Nylon	Urethane	
4	6	KGD04-06	10.4	12.8	35.5	18.2	10.4	21	9.7	16	17	4.2	4.2	10
6	8	KGD06-08	12.8	15.2	40.5	20.3	12.8	26	11.7	17	18.5	13.4	10.6	17

Plug-in Reducer: KGR

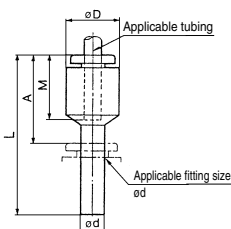

Applicable tubing O.D. (mm)	Applicable fitting size ϕd	Model	ϕD	L	A	M	Effective area (mm ²) ^{Note}		Weight (g)
							Nylon	Urethane	
4	6	KGR04-06	10.4	34.5	17.5	16	5.6	4	1.8
	8	KGR04-08		36.5	18				2.0
	10	KGR04-10		39.5	18.5				3.3
6	4	KGR06-04	12.8	37	21	17	13.1	10.4	4
	8	KGR06-08		37	18.5				2.5
	10	KGR06-10		39.5	20				3
	12	KGR06-12		42	22				4.7
8	10	KGR08-10	15.2	41	20	18.5	26.1	18.0	4.0
	12	KGR08-12		42	20				4.6
	16	KGR08-16		44.5	23				21
10	12	KGR10-12	20.9	50.5	25.5	22	58.3	(46.1)	37
	16	KGR10-16		50.5	25.5				41.5
12	16	KGR12-16	20.9	50.5	25.5	22	58.3	(46.1)	37

Note (): Values for soft nylon.



Bulkhead Union: KGE

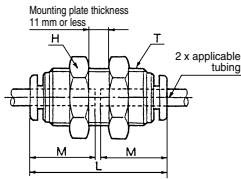

Applicable tubing O.D. (mm)	Model	T(M)	H (width across flats)	L	Mounting hole	M	Effective area (mm ²) ^(Note)		Weight (g)
							Nylon	Urethane	
4	KGE04-00	M12 x 1	14	32.5	13	16	5.6	4	26
6	KGE06-00	M14 x 1	17	34.5	15	17	13.1	10.4	33
8	KGE08-00	M16 x 1	19	38	17	18.5	26.1	18.0	52
10	KGE10-00	M20 x 1	24	42.5	21	21	41.5	29.5	70
12	KGE12-00	M22 x 1	27	44	23	22	58.3	46.1	90
16	KGE16-00	M28 x 1.5	32	51	29	25	113	(96)	115

Note () : Values for soft nylon.

Bulkhead Connector: KGE

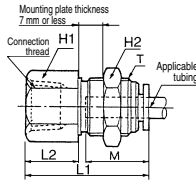

Applicable tubing O.D. (mm)	Connection thread Rc thread	Model	T(M)	H1 (width across flats)	H2 (width across flats)	L1	L2	Mounting hole	M	Effective area (mm ²) ^(Note)		Weight (g)
										Nylon	Urethane	
4	1/6	KGE04-01	M12 x 1	14	14	27.5	11	13	16	5.6	4	16
	1/4	KGE04-02		31		15	35					
6	1/6	KGE06-01	M14 x 1	17	17	28	11	15	17	13.1	10.4	30
	1/4	KGE06-02				31.5	15					29
	3/8	KGE06-03				33.5	17					29
8	1/6	KGE08-01	M16 x 1	17	19	27.5	7.5	17	18.5	26.1	18.0	28
	1/4	KGE08-02				33	13					27
	3/8	KGE08-03				35	15					48
10	1/4	KGE10-02	M20 x 1	22	24	34.5	12.5	21	21	41.5	29.5	53
	3/8	KGE10-03				36.5	14					67
12	3/8	KGE12-03	M22 x 1	24	27	37	14	23	22	58.3	46.1	92
	1/2	KGE12-04				41	18					59
16	3/8	KGE16-03	M28 x 1.5	30	32	40	14	29	25	96	(96)	127
	1/2	KGE16-04				44	18					132

Note () : Values for soft nylon.

Tube Cap: KGC

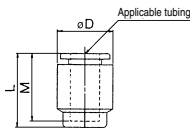

Applicable tubing O.D. (mm)	Model	øD	L	M	Weight (g)
4	KGC04-00	10.4	17	16	3
6	KGC06-00	12.8	18.5	17	3
8	KGC08-00	15.2	20.5	18.5	4
10	KGC10-00	18.5	23	21	6
12	KGC12-00	20.9	24	22	8
16	KGC16-00	26.5	28	25	13



1 Grease-free Specifications

Symbol	Specifications
X17	Grease-free Rubber material: NBR (With fluorine coating) Release button color: Light blue
X39	Grease-free Rubber material: NBR (With fluorine coating) Release button color: Light blue Clean (Air blow, double package)
X94	Grease-free Rubber material: FKM (With fluorine coating) Release button color: Light blue

Suffix "-X17" to the end of part number.

Example) **KGH06-01-X17**

2 Other Specifications

Symbol	Specifications
X12	Lubricant: White Vaseline Release button color: White
X34	Rubber material: FKM

Spare Parts

Description	Part no.	Applicable thread	Applicable model
Gasket	M-5G2	M5	—
	KG04-P01	—	KGE04-00, KGE04-01, KGE04-02
Pipe nut	KG06-P01	—	KGE06-00, KGE06-01 KGE06-02, KGE06-03
	KG08-P01	—	KGE08-00, KGE08-01 KGE08-02, KGE08-03
	KG10-P01	—	KGE10-00, KGE10-02, KGE10-03
	KG12-P01	—	KGE12-00, KGE12-03, KGE12-04
	KG16-P01	—	KGE16-00, KGE16-03, KGE16-04